

## **BD. BERMUDA DUNES AIRPORT**

### **BD.1 Compatibility Map Delineation**

- 1.1 *Airport Master Plan Status:* As a privately owned facility, no master plan has been prepared for Bermuda Dunes Airport. The *Compatibility Plan* is based upon the airport layout plan prepared by the airport owner in 2001.
- 1.2 *Airfield Configuration:* No changes in the existing configuration of the airport runway or approaches is anticipated.
- 1.3 *Airport Activity:* The *Compatibility Plan* for Bermuda Dunes Airport anticipates that the airport could eventually reach approximately 75,000 annual operations, an 80% increase over its estimated present activity level. This beyond-20-year projection is assumed to be the airport's capacity and is based upon the aircraft parking constraints. Activity at Bermuda Dunes Airport is highly seasonal. Airport management records indicate that average days during the peak (Winter) season experience twice the number of aircraft operations as the annual average day and peak days can produce even higher activity levels. Noise contours reflecting the ultimate activity levels on an average day of the peak season are used for the purposes of the *Compatibility Plan*.
- 1.4 *Airport Influence Area:* Two factors are the primary determinants of the Bermuda Dunes Airport influence area. To the north and south the outer edge of the FAR Part 77 conical surface defines the boundary. To the northeast, east, and west, extensions are provided along the runway approach and departure routes reflecting the traffic patterns and noise impacts of jet aircraft operations.

### **BD.2 Additional Compatibility Policies**

- 2.1 None.

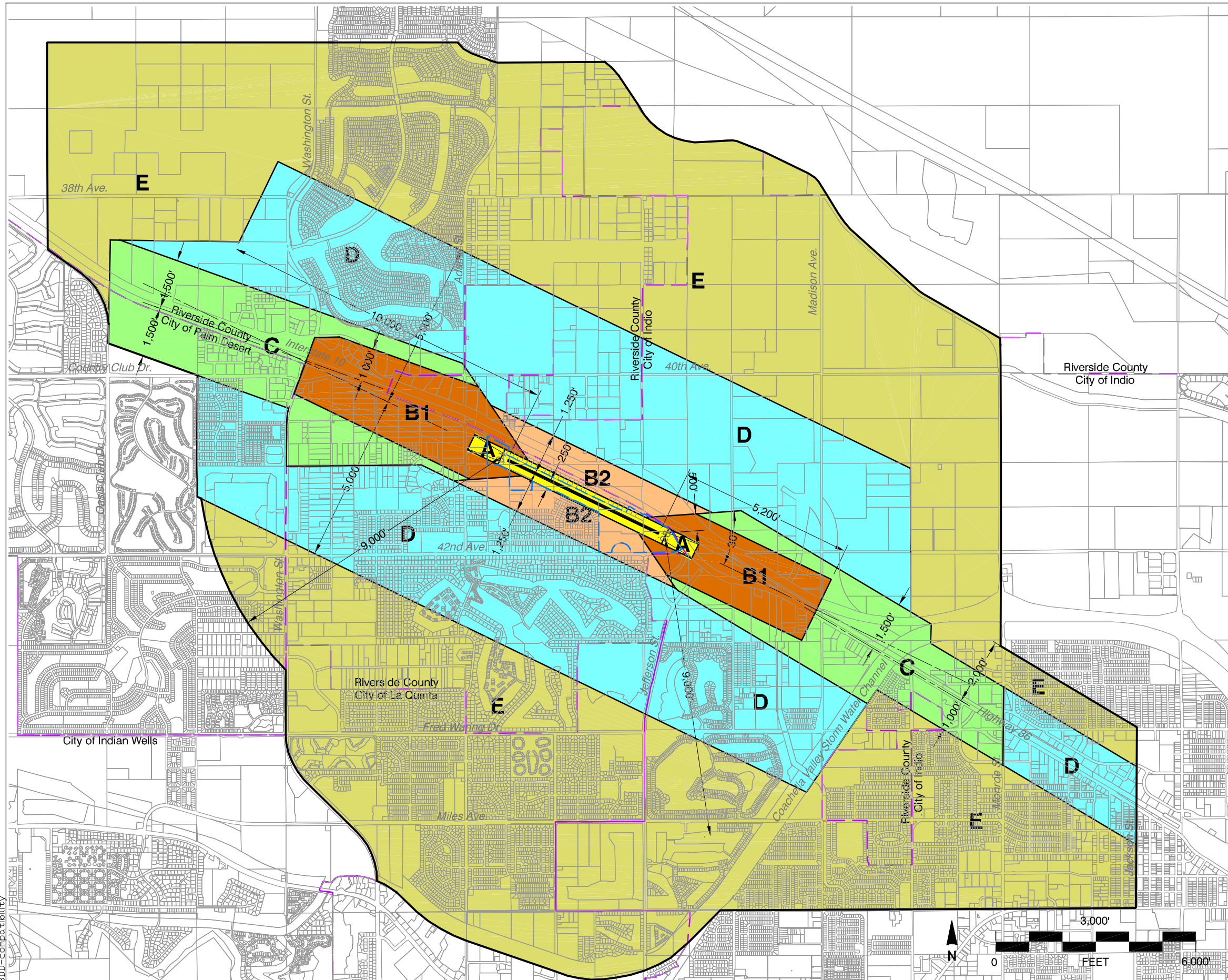

**Legend**

Compatibility Zones

- Airport Influence Area Boundary
- Zone A
- Zone B1
- Zone B2
- Zone C
- Zone D
- Zone E

Boundary Lines

- Airport Property Line
- City Limits

**Note**

Southwestern edge of Airport Influence Area boundary measured from a point 200 feet beyond runway ends in accordance with FAA airspace protection criteria (FAR Part 77). All other dimensions measured from runway ends and centerlines.

See Chapter 2, Table 2A for compatibility criteria associated with this map.

**Riverside County**  
**Airport Land Use Commission**  
**Riverside County**  
**Airport Land Use Compatibility Plan**  
**Policy Document**  
 (Adopted December 2004)

Map BD-1

**Compatibility Map**  
**Bermuda Dunes Airport**

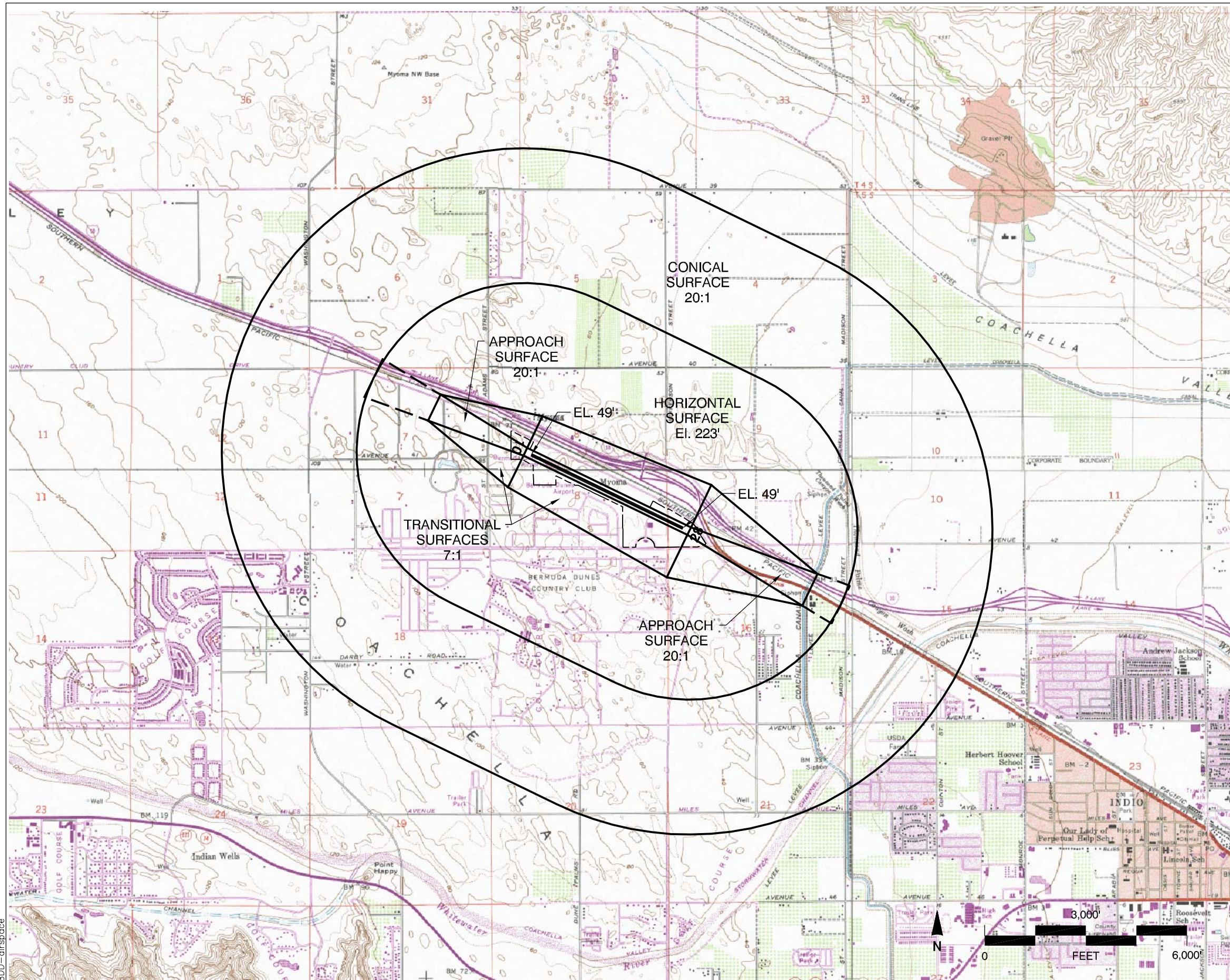

Note: No ground penetrations of depleted FAR Part 77 Surfaces

Riverside County  
 Airport Land Use Commission  
**Riverside County  
 Airport Land Use Compatibility Plan  
 Policy Document**  
 (Adopted December 2004)

Map BD-2

**Airspace Plan**  
 Bermuda Dunes Airport

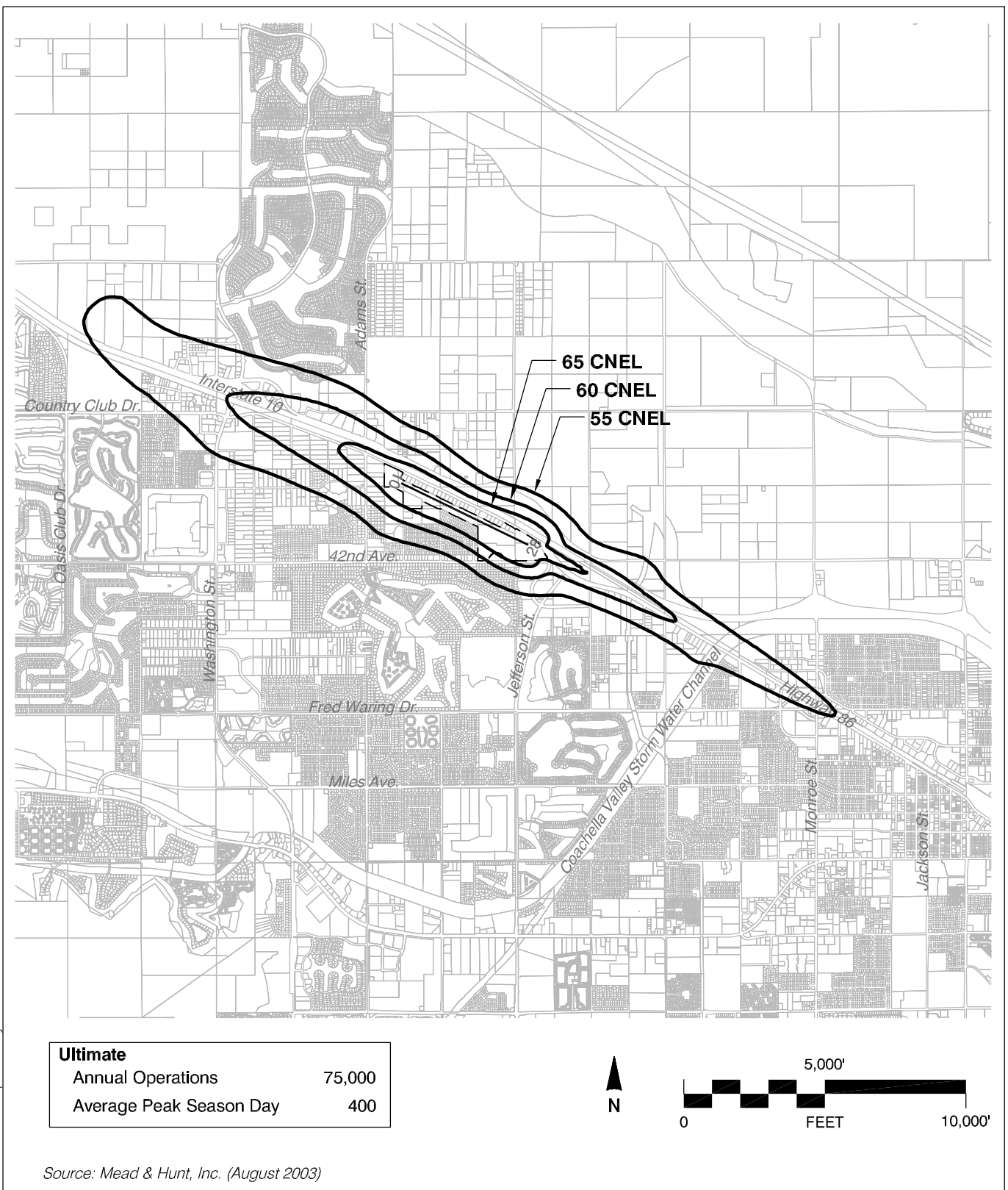

BDD-noise-compatibility

**Map BD-3**

## Noise Compatibility Contours

### Bermuda Dunes Airport